

Licensing Panel (Licensing Act 2003 Functions)

Date: **30 May 2022**

Time: **10.00am**

Venue **Virtual**

Members: **Councillors:** Davis, Moonan and Simson

Contact: **Clare Chapman**
Democratic Services Officer
01273 291515
clare.chapman@brighton-hove.gov.uk

Agendas and minutes are published on the council's website www.brighton-hove.gov.uk.
Agendas are available to view five working days prior to the meeting date.

Electronic agendas can also be accessed through our meetings app available through
ModernGov: [iOS/Windows/Android](#)

This agenda and all accompanying reports are printed on recycled paper

AGENDA

1 TO APPOINT A CHAIR FOR THE MEETING

WELCOME & INTRODUCTIONS

2 PROCEDURAL BUSINESS

(a) **Declaration of Substitutes:** Where Councillors are unable to attend a meeting, a substitute Member from the Licensing Committee may attend, speak and vote in their place for that meeting.

(b) **Declarations of Interest:**

- (a) Disclosable pecuniary interests;
- (b) Any other interests required to be registered under the local code;
- (c) Any other general interest as a result of which a decision on the matter might reasonably be regarded as affecting you or a partner more than a majority of other people or businesses in the ward/s affected by the decision.

In each case, you need to declare

- (i) the item on the agenda the interest relates to;
- (ii) the nature of the interest; and
- (iii) whether it is a disclosable pecuniary interest or some other interest.

If unsure, Members should seek advice from the committee lawyer or administrator preferably before the meeting.

(c) **Exclusion of Press and Public:** To consider whether, in view of the nature of the business to be transacted, or the nature of the proceedings, the press and public should be excluded from the meeting when any of the following items are under consideration.

NOTE: Any item appearing in Part Two of the Agenda states in its heading the category under which the information disclosed in the report is exempt from disclosure and therefore not available to the public.

A list and description of the exempt categories is available for public inspection at Brighton and Hove Town Halls.

3 JUMPS DELICATESSEN

7 - 26

Contact Officer: Emily Fountain

Tel. 01273 292143

Ward Affected: Westbourne

Date of Publication - Friday, 20 May 2022

The City Council actively welcomes members of the public and the press to attend its meetings and holds as many of its meetings as possible in public. Provision is also made on the agendas for public questions to committees and details of how questions can be raised can be found on the website and/or on agendas for the meetings.

The closing date for receipt of public questions and deputations for the next meeting is 12 noon on the fourth working day before the meeting.

Meeting papers can be provided, on request, in large print, in Braille, on audio tape or on disc, or translated into any other language as requested.

Infra-red hearing aids are available for use during the meeting. If you require any further information or assistance, please contact the receptionist on arrival.

FURTHER INFORMATION

For further details and general enquiries about this meeting contact Clare Chapman, (01273 291065, email penny.jennings@brighton-hove.gov.uk) or email democratic.services@brighton-hove.gov.uk

WEBCASTING NOTICE

This meeting may be filmed for live or subsequent broadcast via the Council's website. At the start of the meeting the Chair will confirm if all or part of the meeting is being filmed. You should be aware that the Council is a Data Controller under the Data Protection Act 1998. Data collected during this web cast will be retained in accordance with the Council's published policy.

Therefore, by entering the meeting room and using the seats in the chamber you are deemed to be consenting to being filmed and to the possible use of those images and sound recordings for the purpose of web casting and/or Member training. If members of the public do not wish to have their image captured, they should sit in the public gallery area.

ACCESS NOTICE

The Public Gallery is situated on the first floor of the Town Hall and is limited in size but does have 2 spaces designated for wheelchair users. The lift cannot be used in an emergency. Evac Chairs are available for self-transfer and you are requested to inform Reception prior to going up to the Public Gallery. **For your own safety please do not go beyond the Ground Floor if you are unable to use the stairs.**

Please inform staff on Reception of this affects you so that you can be directed to the Council Chamber where you can watch the meeting or if you need to take part in the proceedings e.g. because you have submitted a public question.

FIRE / EMERGENCY EVACUATION PROCEDURE

If the fire alarm sounds continuously, or if you are instructed to do so, you must leave the building by the nearest available exit. You will be directed to the nearest exit by council staff. It is vital that you follow their instructions:

- You should proceed calmly; do not run and do not use the lifts;
- Do not stop to collect personal belongings;
- Once you are outside, please do not wait immediately next to the building, but move some distance away and await further instructions; and
- Do not re-enter the building until told that it is safe to do so.

Licensing Panel (Licensing Act 2003 Functions)

Brighton & Hove City Council

Subject:	Application for a New Premises Licence under the Licensing Act 2003		
Premises:	Jumps Delicatessen 20 Richardson Road Hove BN3 5RB		
Applicant:	Jumps Delicatessen Ltd		
Date of Meeting:	30 May 2022		
Report of:	Executive Director of Housing, Neighbourhoods & Communities		
Contact Officer:	Name:	Emily Fountain	Tel: (01273) 292143
	Email:	emily.fountain@brighton-hove.gov.uk	
Ward(s) affected:	Westbourne		

1. PURPOSE OF REPORT AND POLICY CONTEXT

- 1.1 To determine an application for a New Premises Licence under the Licensing Act 2003 for Jumps Delicatessen.

2. RECOMMENDATIONS:

- 2.1 That the Panel determine an application for a New Premises Licence under the Licensing Act 2003 for Jumps Delicatessen.

3. CONTEXT/BACKGROUND INFORMATION & CONSULTATION

- 3.1 The application is for a New Premises Licence under the Licensing Act 2003. The application proposes that Jumps Delicatessen will sell food for consumption on and off premises. There will be two tables of four outside to the front and three tables of four inside. We intend to serve wine by the glass alongside food orders only. No alcohol for off supplies sales. The hours of service will be limited to 12 - 7pm only Monday-Saturday.

- 3.2 Section 18 (operating schedule) of the application is detailed at Appendix A and the plan of the premises is attached at Appendix B

3.3 Summary table of proposed activities.

	Proposed
Recorded Music	Monday to Saturday 09:00 – 19:00
Supply of Alcohol	Monday to Saturday 12:00-19:00 On the Premises
Hours premises are open to public	Monday to Saturday 08:30 – 19:00

3.4 The premises does not fall in the Cumulative Impact Area or the Special Stress Area.

Representations received

- 3.5 Details of the representations made are notified to applicants on receipt by the Licensing Authority using a pro-format. A summary appears below:
- 3.6 Four representations were received. They were received from local residents.
- 3.7 Representations received had concerns relating to Prevention of Crime and Disorder and Prevention of Public Nuisance.
- 3.8 Full details of the representations are attached at Appendix C. A map detailing the location of the premises is attached at Appendix D.

4 COMMENTARY ON THE LICENSING POLICY

4.1 The following extracts from Brighton & Hove City Council Statement of Licensing Policy are considered relevant to this application and **are numbered as they appear in the policy**:

1 Introduction

1.1 This Statement of Licensing Policy has been prepared in accordance with the provisions of the Licensing Act 2003 (the Act) and having regard to Guidance issued by the Home Office under Section 182 of the act. This policy takes effect from the 4th February 2021. The licensing authority is Brighton & Hove City Council. The purpose of this statement is to promote the licensing objectives and set out a general approach to making licensing decisions. The discretion of the licensing authority in relation to applications under the act is only engaged if 'relevant representations' are made by other persons or responsible authorities. This policy will inform the approach to be taken when deciding applications and imposing conditions when relevant representations are received. It is also intended as a guide for applicants as to what to include in their operating schedules, always recognising that if no representations are received, the application must be granted. The licensing authority must carry out its functions with a view to promoting the licensing objectives and this policy is framed around those objectives. Each

application will be given individual consideration on its merit. The scope of this policy covers the following:

- Retail sales of alcohol.
- The supply of alcohol by or on behalf of a club, or to the order of, a member of the club.
- The provision of regulated entertainment.
- The provision of late night refreshment.

1.2 The licensing objectives are:

- (a) the prevention of crime and disorder.
- (b) public safety.
- (c) the prevention of public nuisance; and
- (d) the protection of children from harm.

1.3 Scope

1.3.1 Licensing is about regulating licensable activities on licensed premises, by qualifying clubs and at temporary events. Any conditions attached to various authorisations will be focused on matters which are within the control of individual licensees and others with relevant authorisations, i.e. the premises and its vicinity. Each application will be given individual consideration on its merit. Nothing in this policy shall undermine the right of any individual to apply under the terms of the act for a variety of permissions and to have any such application considered on its individual merits. Similarly, nothing in this policy shall override the right of any person to make representations on an application or seek a review of a licence or certificate where provision has been made for them to do so in the act.

3.3 The Matrix Approach

The Licensing Authority will support:

3.3.1 Diversity of premises: ensures that there is a mix of the different types of licensed premises and attracts a more diverse range of customers from different age groups, different communities and with different attitudes to alcohol consumption. It gives potential for positively changing the ambience of the city or an area of it. This will have a positive effect in reducing people's fear of crime and in increasing the number of evening visitors to the city centre. The Community Safety Strategy recognises that too many single uses in a confined area and patrons turning out onto the streets at the same time may create opportunities for violent crime and public disorder and therefore supports mixed use venues encouraging a wider age balance.

3.3.2 A "matrix" approach to licensing decisions has been adopted and is set out below. It provides a framework of what the licensing authority would like to see within its area and gives an indication of the likelihood of success or otherwise to investor and businesses making applications.

Matrix approach for licensing decisions in a Statement of Licensing Policy (times relates to licensable activities)

	Cumulative Impact Area	Special Stress Area	Other Areas
Restaurant	Yes (midnight)	Yes (midnight)	Yes (midnight)
Café	Yes (10 pm)	Yes (10 pm)	Yes (10 pm)
Late Night Takeaways	No	Yes (midnight)	Yes (midnight)
Night Club	No	No	No
Pub	No	Yes (11pm)	Yes (midnight)
Non-alcohol lead (e.g. Theatre)	Yes (favourable)	Yes (favourable)	Yes (favourable)
Off-licence	No	No	Yes (Up to 11pm but if in densely residential area may be earlier – see note 7 below)
Members Club (club premises certificate)	Yes (<100 capacity) (11pm)	Yes (<100 capacity) (11pm)	Yes

Notes on matrix

Subject to the following notes, the policy, as represented in the matrix, will be strictly adhered to:

- 1) Each application will be considered on individual merit
- 2) Applications within the CIZ are subject to the special policy on cumulative impact at para 3.1, and those within the special stress area to the special stress policy considerations at para 3.2.
- 3) Departure from the matrix policy is expected only in exceptional circumstances
- 4) Exceptional circumstances will not include quality of management or size of venue except where explicitly stated in policy matrix.
- 5) Exceptional circumstances may include: consultation with and meeting requirements of responsible authorities, an appropriate corporate social responsibility policy, community contribution to offset impact (such as financial contribution to infrastructure), community support, alcohol sale ancillary to business activity (demonstrable to responsible authorities and licensing authority, for instance by licence condition allowing authorised officers access to sales accounts).

6) The following licensing activities are encouraged and valued by the licensing authority: outdoor regulated entertainment, community based street parties, members clubs, traditional pubs outside the city centre and non-alcohol led licensable activities, particularly within city centre.

7) Other Areas; consideration will be given to the nature of the area and location in relation to any application. In a residential area for example the concerns of local residents will be relevant when considering applications for off-licences, pubs or cafes, especially if there is evidence of anti-social behaviour, street drinking or underage drinking. Earlier closing times may be appropriate. Regard will be had to the Public Health Framework for assessing alcohol licensing on our website www.brighton-hove.gov.uk/licensingact.

8) In an area where there are already several existing off-licences or where the premises is situated within a parade with another off licence and where representations are received about negative cumulative impact on the licensing objectives of a further premises, the application may be refused on these grounds or restrictions placed on the terminal hour to reflect opening hours of other shops.

9) Outdoor events will be supported where arranged through the council's event planning process. Generally, regulated entertainment in the open air including tents and marquees should have a maximum closure hour of 2300. Earlier hours may be imposed in sensitive open spaces or near residential areas. The licensing authority will have regard to Noise Council guidance.

10) Non-alcohol led category does not include "alcohol in shared workplaces". It is recommended that sale of alcohol in shared workspaces should have a terminal hour of no later than 10pm. For further advice and guidance on "alcohol in shared workplaces" please see paragraph 3.3.4-3.3.6.

3.3.3 Cafes - the licensing authority may be prepared to look favourably upon an application for the grant of a licence, subject to the following conditions that will prevent the premises becoming a public house.

- The sale of intoxicating liquor and other beverages shall be waiter/waitress service for consumption by persons seated at tables.
- Substantial food shall be available at all times. The licensing authority shall judge each case on its own merits but as a general rule, a bowl of crisps, nuts, or olives does not constitute substantial food.

3.3.3 Restaurants - the licensing authority may be prepared to look favourably upon an application for the grant of a licence, subject to the following restaurant condition.

- Intoxicating liquor shall not be supplied or sold on the premises otherwise than to persons taking table meals there and for the consumption by such a person as an ancillary to their meal. There will be no vertical drinking.
- Restaurants with outside service - the licensing authority will also consider applications from restaurants that request to serve alcohol to areas adjacent to or immediately outside their premises. In addition to the above conditions

for cafes, the licensing authority will require evidence that the applicants have an agreement with the local authority to use the area as defined on a plan provided. The following condition may also apply:

- The sale and supply of alcohol for consumption off the premises shall be restricted to an area licensed by the Local Authority for use of the public highway as shown on the plan deposited and such area shall be defined by a physical barrier acceptable to the licensing authority.

4 Prevention of Crime and Disorder

The following details and measures are intended to address the need for the prevention of crime and disorder which may be associated with licensed premises and certificated club premises. Conditions attached to licences and certificates will, as far as possible, reflect local crime reduction strategies.

- 4.1.1 The licensing authority acknowledges that training and good management play a key part in preventing alcohol and drug related crime. The authority expects that all licensees of on-licensed premises attend training programmes which will raise their awareness of the issues relating to drugs and violence in licensed premises, and that suitable training be extended to all bar staff and door supervisors so that drug dealers and users will be deterred from using licensed premises for illegal purposes and that incidents of violence in licensed premises will be reduced. Licensees are also encouraged to attend training programmes to help identify children at risk and issues of basic child protection. It is the duty of the designated premises supervisor (DPS) to train staff on induction concerning conditions on their premises licence.
- 4.1.2 It is expected that the DPS will spend a significant amount of time on the premises. When not on the premises it will be essential that the DPS is contactable, particularly should problems arise with the premises and that staff are authorised by the DPS.
- 4.1.3 The location of violent attacks, anti-social behaviour and hate crime or related incidents may be used to justify closing times.

6 Prevention of Public Nuisance

The following details and measures are intended to address the need for the prevention of public nuisance which may be associated with licensed premises and certificated club premises:

- 6.1.1 In determining applications for new and varied licences, regard will be had to the location of premises, the type and construction of the building and the likelihood of nuisance and disturbance to the amenity of nearby residents by reason of noise from within the premises, as a result of people entering or leaving the premises or from individuals or groups of customers gathered outside (eg in order to smoke).
- 6.1.2 Applications for new licences or for the extension in size of licensed premises should not normally be granted if the premises will use amplified or live music and operate within or abutting premises containing residential accommodation except that occupied by staff of the licensed premises. A condition may be imposed on new

licences that entertainment noise shall be inaudible in any residence. Noise emanating from within licensed premises should not normally be audible outside.

6.1.5 In determining applications for new licences or extensions in hours or terminal hours of licensed premises, regard will be had to late night public transport availability and location of taxi ranks to aid dispersal of customers.

6.1.6 Reasonable controls are available to all premises operators to minimise the impact of noise from customers outside. The council's Environmental Health Department has issued guidance on a number of steps that can be taken in this respect which are endorsed by this policy (see 6.2 below).

6.2 Smoking Advice

6.2.1 Premises licence holders will be expected to:

- Develop a management plan on how to manage smoking on your premises and ensure that all staff are aware of the contents of this plan, and that it is effectively implemented. Noise from people smoking and talking can be intermittent, vary in character and volume and be intrusive. An effective smoking management plan will help prevent neighbours being disturbed.
- Comply with any planning conditions restricting the use of outdoor areas.
- Ensure that any structures used by smokers comply with the design criteria detailed in the Heath Act 2006 and that any structures, awnings, retractable canopies, etc. have the relevant planning permission.
- Ensure any new lighting to outdoor areas must be designed so as not to cause a light nuisance to neighbours and again have the relevant planning permission and building control consent.
- Ensure that the conditions on the premises licence are complied with. There may be conditions restricting the hours of use of gardens and outdoor areas. Having reviewed the contents of the premises licence you may find it necessary to request a variation of your licence.
- Licence tables and chairs on the Public Highway under the provisions of the Highways Act 1980. These licences may have conditions restricting the times that the area can be used.
- Ensure drinks, glasses and bottles are not taken onto the highway unless there is a tables and chairs licence permitting use. A system should be adopted to prevent theft and 'spiking' of drinks and reminding customers not to leave unattended items.
- Discourage smokers remaining in gardens and outdoor areas and determine terminal hours.
- Discourage smokers remaining outside by removing/disabling tables and chairs or prohibiting their use after a certain time. Lights and heaters will also be turned off.
- Introduce a system that after a certain time the number of smokers outside are restricted to a maximum number. Staff will be needed to manage this restriction.
- Employ staff and/or SIA registered door supervisors to manage doors and control customers and smokers entering and leaving the premises.

Staff positioned on the doors can help to encourage customers not to cause a noise problem. It may be that staff are required to manage doors after a certain time, particularly during the hours when neighbouring residents are trying to sleep.

- Ensure door supervisors maintain order outside venues and protect customer safety. BCRP supports the use of Night Safe. Radio net and other pager systems and pub watch schemes can be used to provide for rapid police response and alert other venues where customers and staff are endangered.
- Position signs to remind customers that the premises is in an area where people live. It is not always obvious in busy commercial streets with flats above. By changing the design and wording of signs customers do not forget. Signs can be located in and outside the premises and on tables.
- Use CCTV to manage outside areas.

6.2.2 Licensed premises should normally display prominent, legible signs at exits reminding customers to leave in a quiet, peaceful, orderly manner.

8 Integration of Strategies

8.1.1 The licensing authority shall secure the proper integration of this policy with local crime prevention, planning policy, transport, tourism and cultural strategies by:-

- Liaising and consulting with the Sussex Police, Community Safety Forum, Sustainability Commission representatives and following the guidance in community safety and crime and disorder strategy
- Liaising and consulting with Public and Alcohol Programme Board
- Liaising and consulting with the East Sussex Fire & Rescue Service
- Liaising and consulting with the Local Strategic Partnership, Safety Advisory Group (Emergency Planning) and Equalities and Social Justice Consultation Forum
- Liaising and consulting with the Planning authority
- Liaising and consulting with the Highways authority
- Liaising and consulting with local business and business associations. Having regard to any future documents issued relating to the Private Security Industry Act 2001, for example liaison or information sharing protocols
- Liaising and consulting with the Trading Standards Team, for example with regard to test purchasing codes of practice

8.1.2 In line with statutory requirements and the council's Inclusion Policy, the Licensing Authority shall have due regard to the need to eliminate unlawful discrimination, and to promote equality of opportunity and positive relations between persons of diverse backgrounds, for example communities of interest such as: lesbian, gay, bisexual and transgender people; disabled people; racial and ethnic groups; religious and faith groups.

8.1.3 This policy supports the aims of the tourism strategy, recognising the benefits for the tourism economy of creating a safer and more attractive city centre and improving competitiveness with other European cities. The Licensing Committee should receive any reports relevant to the needs of the local tourist economy and

the cultural strategy for the area to ensure that it considers these matters.

8.1.4 The Licensing Committee should receive relevant information relating to the employment situation of the area and the need for new investment and employment where appropriate.

8.1.5 Specific conditions may be attached to premises licences to reflect local crime prevention strategies. Such conditions may include the use of closed circuit television cameras, use of the NightSafe radio system or accredited scheme, the provision and use of shatterproof drinking receptacles, drugs and weapons search policy, the use of registered door supervisors, specialised lighting requirements, hours of opening. Certificates issued to club premises shall reflect local crime prevention strategies and may include any or all of the requirements listed above.

8.1.6 The licensing authority will have regard to the need to disperse people quickly and safely from the city centre to avoid concentrations which may produce disorder and disturbance.

5. FINANCIAL & OTHER IMPLICATIONS:

Financial Implications:

5.1 The licensing Act 2003 provides for fees to be payable to the licensing authority in respect of the discharge of their functions. The fee levels are set centrally at a level to allow licensing authorities to fully recover the costs of administration, inspection and enforcement of the regime.

Finance Officer Consulted Michael Bentley

Date: 05/05/2022

Legal Implications:

5.2 The licensing authority must act to promote the four licensing objectives which are:

- The prevention of crime and disorder
- Public safety
- The prevention of public nuisance
- The protection of children from harm

The licensing authority must have regard to its statement of licensing policy and the guidance issued by the Secretary of State in carrying out its functions.

Lawyer Consulted: Rebecca Sidell

Date: 05.05.2022

Equalities Implications:

5.3 Diversity is valued and strong, safe communities are vital to future prosperity. Licensing policy aims to protect children from harm including sale and supply of alcohol to children.

Sustainability Implications:

- 5.4 Licensing policy aims to prevent public nuisance and develop culture of live music, dancing and theatre.

SUPPORTING DOCUMENTATION

Appendices:

1. Appendix A - Section 18 (operating schedule)
2. Appendix B – Plan of Premises
3. Appendix C – Representations
4. Appendix D – Map of area

Documents in Members' Rooms

Brighton & Hove City Council, Licensing Act 2003: Statement of Licensing Policy 2021.

Home Office, Revised Guidance issued under section 182 of the Licensing Act 2003, April 2018.

Public Health Framework for assessing Alcohol Licensing. Annual Report – Ward. 5th edition. Public Health Intelligence. January 2019

Background Documents

Brighton & Hove City Council, Licensing Act 2003: Statement of Licensing Policy 2021.

Appendix A

Section 18 of 21
LICENSING OBJECTIVES
Describe the steps you intend to take to promote the four licensing objectives: a) General – all four licensing objectives (b,c,d,e) List here steps you will take to promote all four licensing objectives together. I will ensure that all times there are sufficient competent staff on duty at the premises for the purpose of fulfilling the terms and conditions of the licence and for preventing crime and disorder. I will ensure that all staff will undertake training in relation to the sale of alcohol, particularly with regard to drunkenness and underage persons. Records will be kept of training and refresher training.
b) The prevention of crime and disorder Any incidents of a criminal nature that may occur on the premises will be reported to the Police. I will install comprehensive CCTV at the premises. The CCTV system shall conform to the following points: 1. observe the entrance and exit doors both inside and outside. 2. capture full frame shots of the heads and shoulders of all people entering the premises capable of identification. 3. Cameras viewing till areas must capture frames not less than 50% of screen. 4. Cameras overlooking floor areas should be wide angled to give an overview of the premises. 5. Be capable of visually confirming the nature of the crime committed. 6. Provide a linked record of the date, time and place of any image. 7. Provide good quality images –colour during opening times. 8. Operate under existing light levels within and outside the premises. 9. Have the recording device located in a secure area or locked cabinet. 10. Have a monitor to review images and recorded picture quality. 11. Be regularly maintained to ensure continuous quality of image capture retention. 12. Have signage displayed in the customer area to advise that CCTV is in operation. 13. Digital images will be kept for 31 days. 14. Police will have access to images at any reasonable time. 15. The equipment must have a suitable export method, e. G. CD/DVD writer. Copies will be made available to Police on request.
c) Public safety Appropriate fire safety procedures will in place including fire extinguishers (foam, H2O and CO2), fire blanket, internally illuminated fire exit signs, numerous smoke detectors and emergency lighting All emergency exits shall be kept free from obstruction at all times.
d) The prevention of public nuisance All customers will be asked to leave quietly. Clear and legible notices will be prominently displayed to remind customers to leave quietly and have regard to our neighbours.
<i>Continued from previous page...</i>
e) The protection of children from harm All staff will ask persons who appear to be under the age of 25 for photographic ID such as proof of age cards photographic driving license or passport, an official identity card bearing the photograph and date of birth of bearer. All staff will be trained for underage sales prevention regularly. A register of refused sales shall be kept and maintained on the premises.

Appendix B

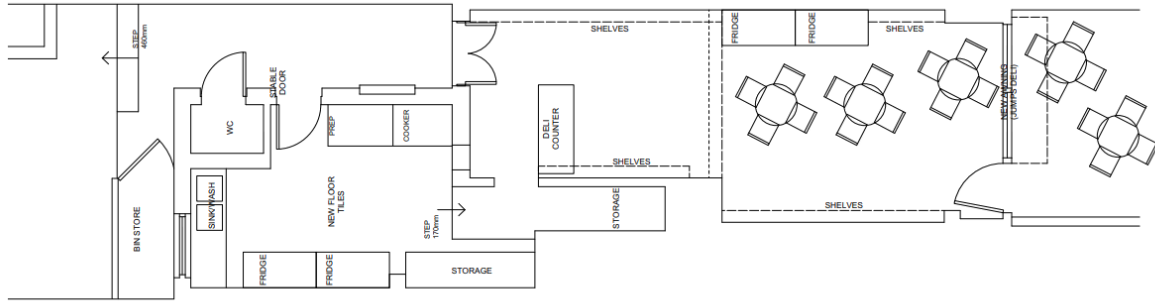

PROPOSED PLAN
Scale 1:50 @ A3

These drawings are prepared in accordance with the Building Regulations 2010. The drawings are not to be used for any other purpose without the written consent of the architect. All drawings are subject to the architect's approval. The architect is not responsible for the accuracy of the information provided in these drawings. The architect is not responsible for the accuracy of the information provided in these drawings. The architect is not responsible for the accuracy of the information provided in these drawings.

Project No.	10/10/10/10/10
Client Name	ABC Company Ltd
Project Name	ABC Company Ltd
Scale	1:50 @ A3
Date	20/10/10
Drawn by	ABC Company Ltd
Checked by	ABC Company Ltd

Appendix C

From: REDACTED

Sent: 08 April 2022 08:16

To: EHL Safety <EHL.Safety@brighton-hove.gov.uk>

Cc: REDACTED

Subject: Objection to the request for an alcohol licence on Richardson Road

EF CON ENDS 18.04.22 VALID PPN (A)

Dear Sir/Madam,

I would like to place an objection for JUMPS DELICATESSEN LTD at 20 Richardson Road, Hove, BN3 5RB to be issued an alcohol licence.

The objection is based on the future change their alcohol licence will bring to the local community, peace and safety of residents and the area.

Currently the gem of Hove, Richardson Road attracts local visitors to cafes to enjoy quiet breakfast/lunch/brunch with soft drinks. All local businesses on the road are very quiet and currently the road becomes very quiet at 5pm on in the week and 3ish at weekends.

By allowing JUMPS DELICATESSEN LTD to sell alcohol by glass till 7pm the cafe will increase people and vehicle traffic effecting local community, will create incidents under alcohol influence and decrease safety for local adult residents, children and pets. Last orders taken by 7 pm do not mean cafe guests will finish their drinking by 7 pm. Allowing alcohol to be served will ruin REDACTED and create a massive amount of noise pollution going forward.

Considering the adverse effect we have already seen from the reopening of Rockwater, where we have people shouting and occasionally throwing traffic cones or whatever they find on our street in the early hours of Saturday and Sunday morning we feel our street has already had to take an unnecessary hit and would like it to stop there please. We personally have accepted this for the good of Hove but would like it to stop there please.

We moved to REDACTED due to the quiet, sleepy and friendly vibe and we love our local community and neighbours. Please don't ruin it.

Thanks for the opportunity to give our opinion.

Regards,

REDACTED

From: REDACTED

Sent: 18 April 2022 17:35

To: EHL Safety <EHL.Safety@brighton-hove.gov.uk>

Subject: Jumps Delicatessen Ltd Licence - 1445/3/2022/00630/LAPREN

EF CON ENDS 18.04.22 VALID PPN & PCD (B)

Dear Sirs

Jumps Delicatessen Ltd Licence - 1445/3/2022/00630/LAPREN

I am writing to register my objection to the licensing application by Jumps Delicatessen Ltd, 20 Richardson Road, Hove, BN3 5RB. I am a resident of REDACTED and believe that granting this application fails to fulfil the licensing objectives to prevent crime, disorder, nuisance, public safety and protection of children from harm.

Richardson Road is a successful community of businesses and residents during the day but after 4pm is a quiet residential road. The granting of this licence has the potential to introduce a night time economy to the road by stealth to the detriment of its residents. The property is neighboured and overlooked by many residential properties and gardens and the playing of music into the evening will be a nuisance to these people particularly in the summer months when people have to have their windows open. The road is home to several vulnerable elderly people as well as families with children who will be harmed by this and not be able to rest and sleep due to this noise. Added to this the sale of alcohol lends to an increased likelihood of noise nuisance as well as crime, disorder and antisocial behaviour. And with that comes a risk to property and public safety. The local area is already catered for with regards to licensed premises by businesses on Portland Road, Church Road and the seafront.

In view of the above I would urge you to refuse the application.

Yours faithfully.

REDACTED

From: REDACTED

Sent: 18 April 2022 17:03

To: EHL Safety <EHL.Safety@brighton-hove.gov.uk>

Subject: Jumps delicatessen 20 Richardson Road BN3 5RB

EF CON ENDS 18.04.22 VALID PPN & PCD (C)

I am writing to register an objection to the application for for a premises licence.

The road is a vibrant community during the day but after 4pm it is a quiet residential road.

There are residential properties surrounding the delicatessen with elderly people and young families. I believe serving alcohol and playing amplified music will cause a local noise disturbance and negatively impact the lives of our young children whose bedrooms look out directly onto the street.

I would also like to object on the grounds of antisocial behaviour, amplified music and alcohol risks raised voices, loitering and public urination.

Kind regards,

REDACTED

From: REDACTED

Sent: 18 April 2022 17:03

To: EHL Safety <EHL.Safety@brighton-hove.gov.uk>

Subject: Jumps delicatessen 20 Richardson Road BN3 5RB

EF CON ENDS 18.04.22 VALID PPN & PCD (D)

I am writing to register an objection to the application for for a premises licence.

The road is a vibrant community during the day but after 4pm it is a quiet residential road.

There are residential properties surrounding the delicatessen with elderly people and young families. I believe serving alcohol and playing amplified music will cause a local noise disturbance and negatively impact the lives of our young children whose bedrooms look out directly onto the street.

I would also like to object on the grounds of antisocial behaviour, amplified music and alcohol risks raised voices, loitering and public urination.

Kind regards,

REDACTED

Appendix D

